

# Grossmann Hall Addition

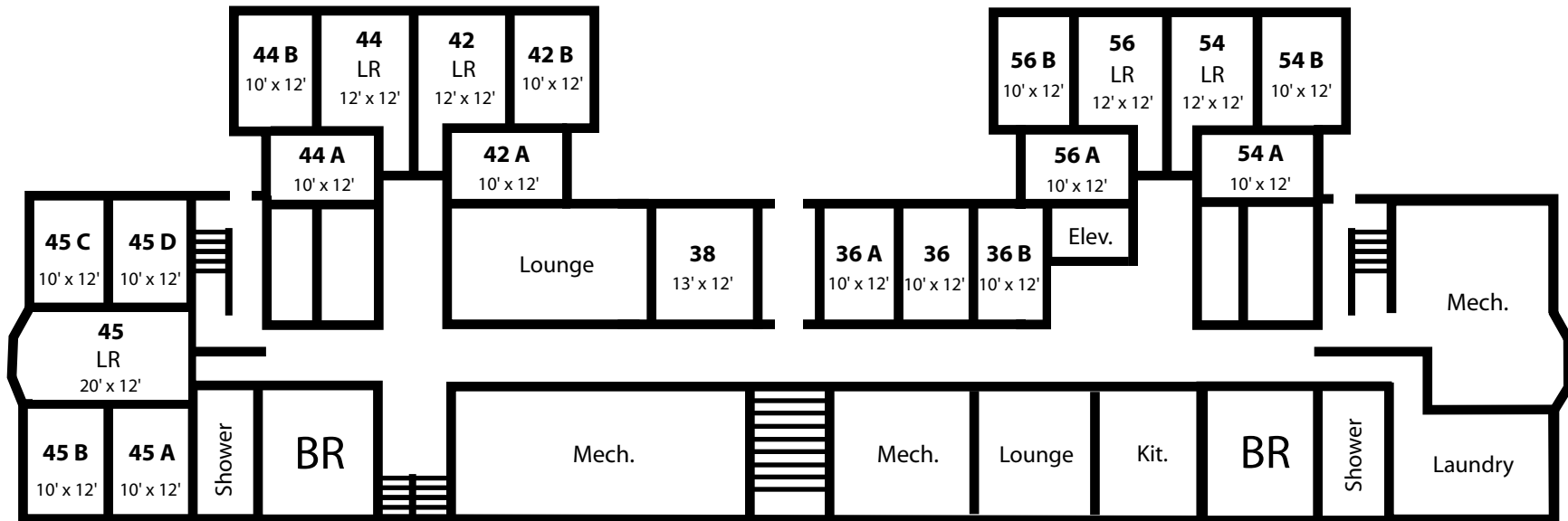

## Ground Floor

(Room dimensions are approximate within four inches.)  
 Closets are not included in dimensions or on this floor plan.  
 Single window dimensions - 2'8" x 4'  
 Living Room window dimensions - 6'8" x 4'





# Löhe Hall

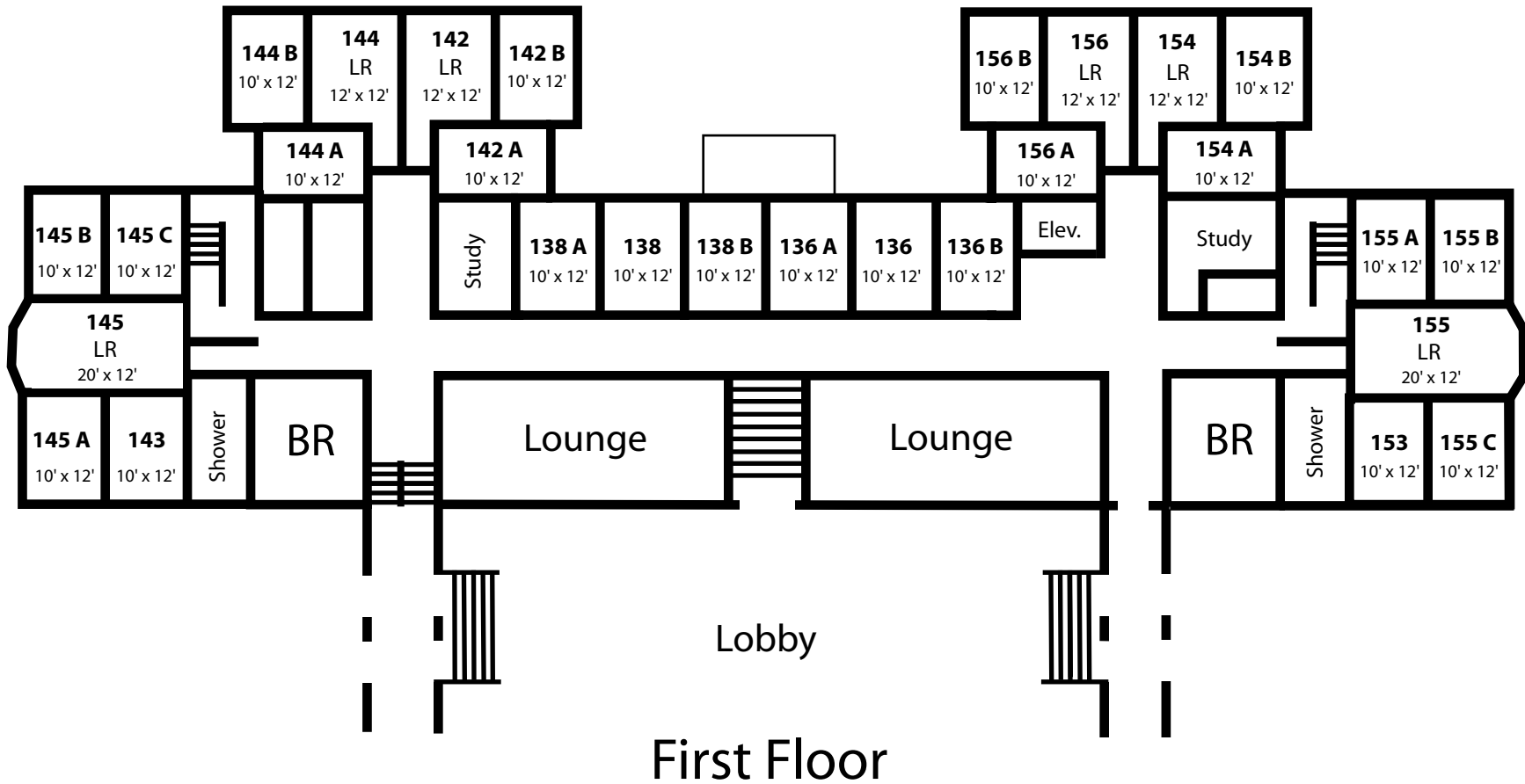

(Room dimensions are approximate within four inches.)  
Closets are not included in dimensions or on this floor plan.

Single window dimensions - 2'8" x 4'  
Living Room window dimensions - 6'8" x 4'





# Löhe Hall

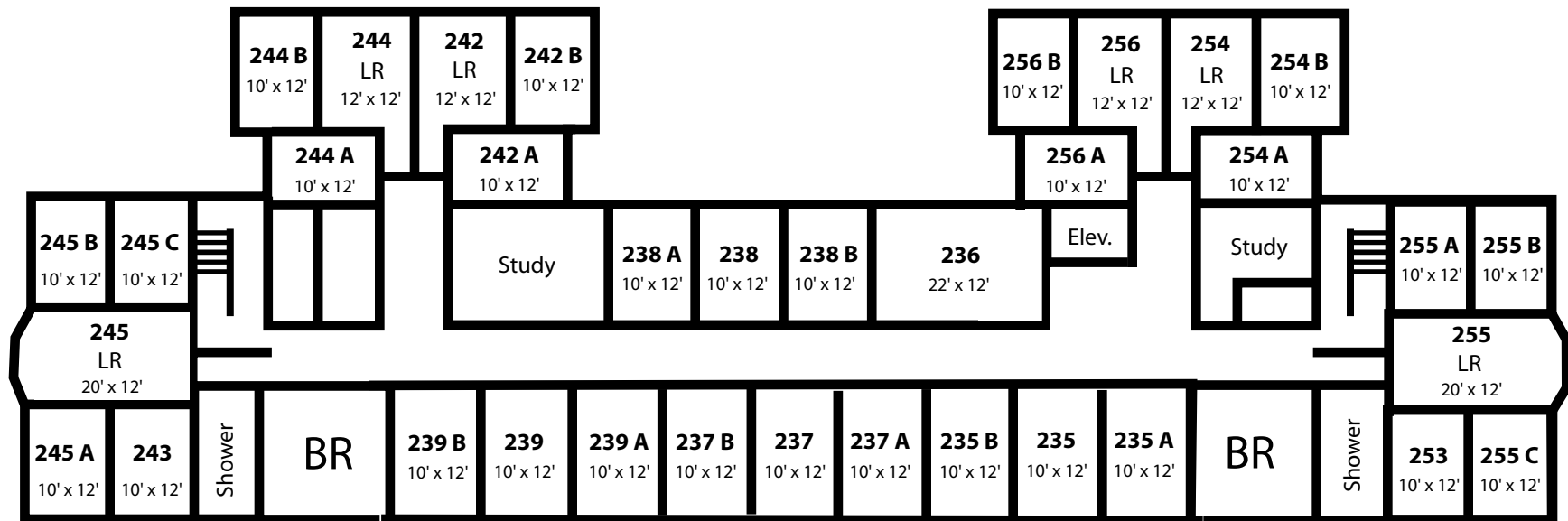

## Second Floor

(Room dimensions are approximate within four inches.)  
Closets are not included in dimensions or on this floor plan.  
Single window dimensions - 2'8" x 4'  
Living Room window dimensions - 6'8" x 4'





# Löhe Hall

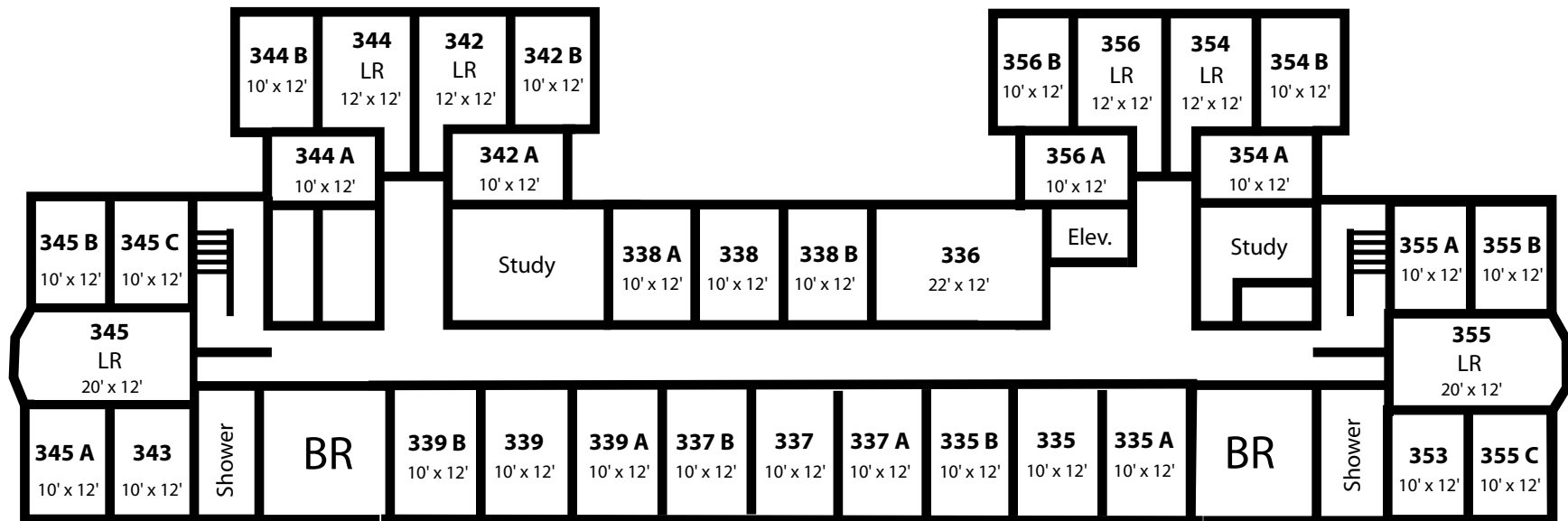

## Third Floor

(Room dimensions are approximate within four inches.)  
Closets are not included in dimensions or on this floor plan.  
Single window dimensions - 2'8" x 4'  
Living Room window dimensions - 6'8" x 4'

